

0.9° 42mm 大力距混合式步进电机

A10

项目	技术参数
步距角	0.9°
步距角精度	±5% (整步, 空载)
电阻精度	±10%
电感精度	±20%
温升	80° C Max.(额定电流,2 相通电)
环境温度	-20° C~+50° C
绝缘电阻	100M Ω Min. ,500VDC
耐压	500VAC 一分钟
径向间隙	0.02Max. (450 g 负载)
轴向间隙	0.08Max. (450 g 负载)
径向最大负载	28N (距法兰面 20mm)
轴向最大负载	10N

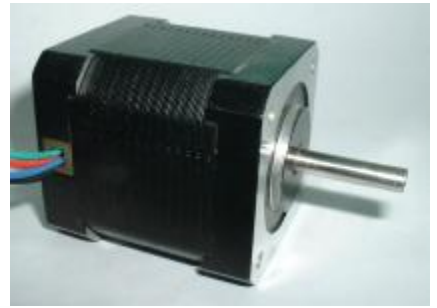

I 42mm 大力距混合式步进电机技术参数

型号.		额定电压	电流 /相	电阻 /相	电感 /相	静力矩	引出线	转动惯量	重量	定位力矩	机身长度
单轴	双轴	V	A	Ω	mH	Kg-cm		g-cm ²	kg	g-cm	mm
BL42STH33-0956MA	BL42STH33-0956MB	4	0.95	4.2	4	1.58	6	35	0.22	200	33
BL42STH33-0606MA	BL42STH33-0606MB	6	0.6	10	9.5	1.58	6				
BL42STH33-0316MA	BL42STH33-0316MB	12	0.31	38.5	33	1.58	6				
BL42STH33-1334MA	BL42STH33-1334MB	2.8	1.33	2.1	4.2	2.2	4	54	0.28	220	40
BL42STH38-1206MA	BL42STH38-1206MB	4	1.2	3.3	3.4	2.59	6				
BL42STH38-0806MA	BL42STH38-0806MB	6	0.8	7.5	6.7	2.59	6				
BL42STH38-0406MA	BL42STH38-0406MB	12	0.4	30	30	2.59	6	68	0.35	250	48
BL42STH38-1684MA	BL42STH38-1684MB	2.8	1.68	1.65	3.2	3.3	4				
BL42STH47-1206MA	BL42STH47-1206MB	4	1.2	3.3	4	3.17	6				
BL42STH47-0806MA	BL42STH47-0806MB	6	0.8	7.5	10	3.17	6	68	0.35	250	48
BL42STH47-0406MA	BL42STH47-0406MB	12	0.4	30	38	3.17	6				
BL42STH47-1684MA	BL42STH47-1684MB	2.8	1.68	1.65	4.1	4.4	4				

尺寸

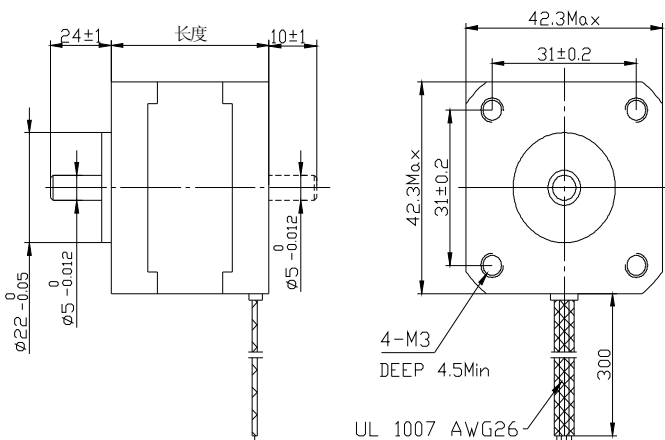

接线图

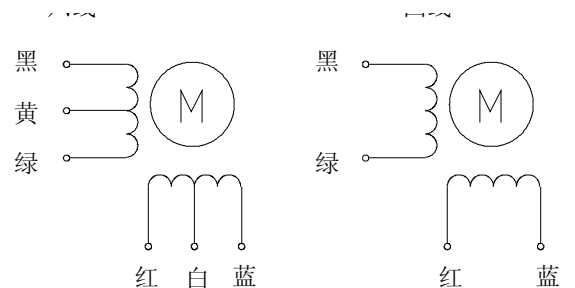

I 距频曲线

A11

BL42STH33-0956MA

VM: 24VDC; 1.00A /相 驱动器: LW415, 整步

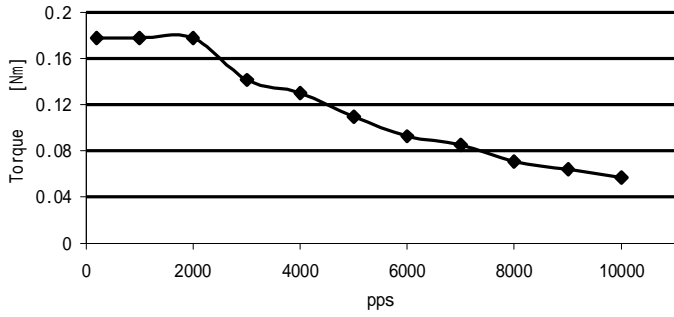

BL42STH33-0606MA

VM: 24VDC; 0.6A /相 驱动器: LW415B, 整步

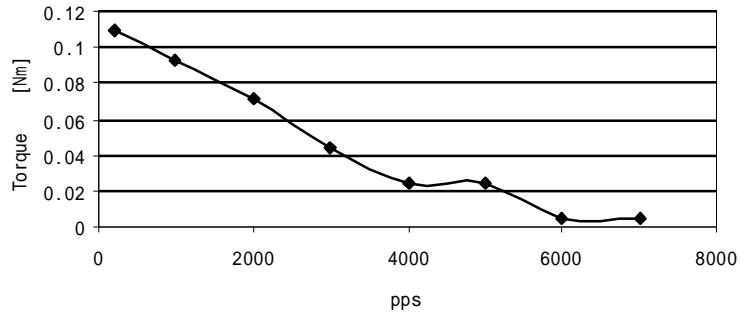

BL42STH33-0316MA

VM: 24VDC; 0.31A /相 驱动器: LW415, 整步

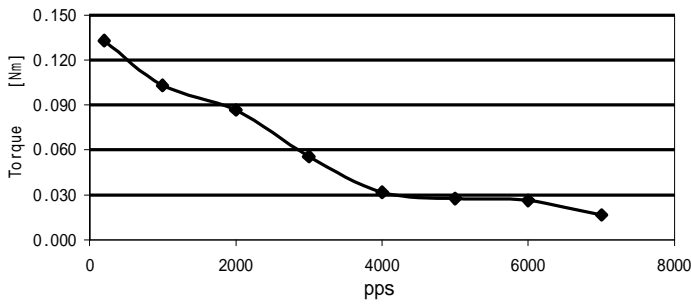

BL42STH33-1334MA

VM: 24VDC; 1.27A /相 驱动器: HA335, 整步

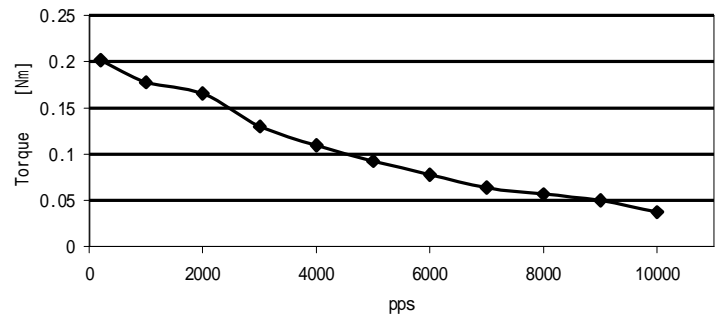

BL42STH38-1206MA

VM: 24VDC; 1.2A /相 驱动器: HA335, 整步

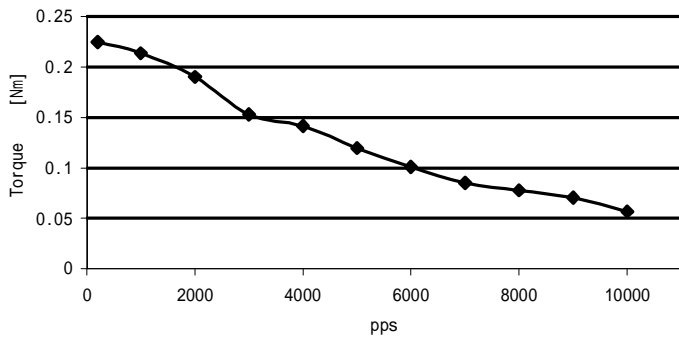

BL42STH38-0806MA

VM: 24VDC; 0.78A /相 驱动器: M325, 整步

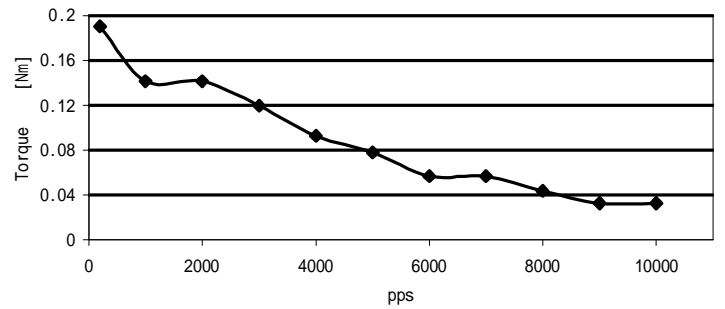

BL42STH38-0404MA

VM: 24VDC; 0.4A /相 驱动器: M325, 整步

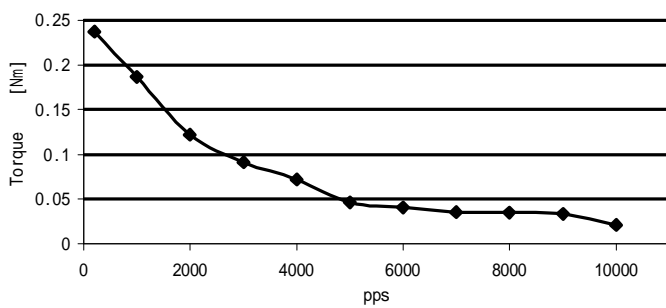

BL42STH38-1684MA

VM: 24VDC; 1.68A /相 驱动器: HA335, 整步

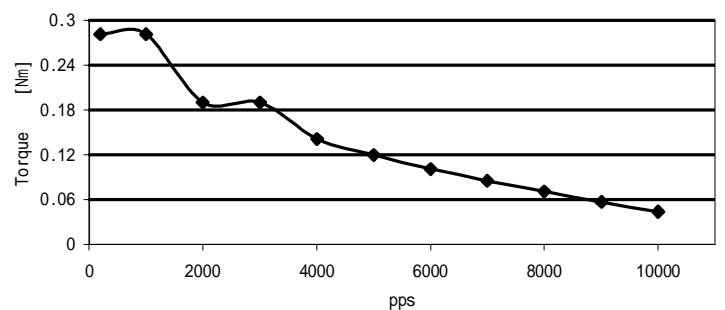

I 距频曲线

A12

BL42STH47-1206MA
VM: 24VDC; 1.2A /相 驱动器: HA335, 整步

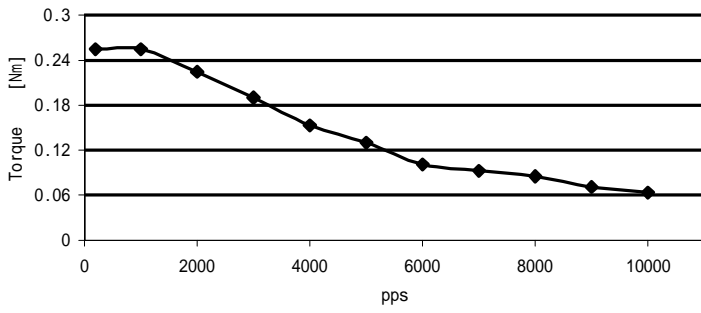

BL42STH47-0806MA
VM: 24V; 0.84A /相 驱动器: HA335, 整步

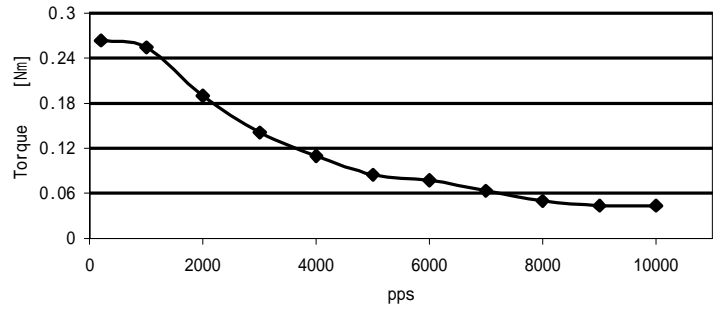

BL42STH47-0406MA
VM: 24VDC; 0.4A /相 驱动器: M325, 整步

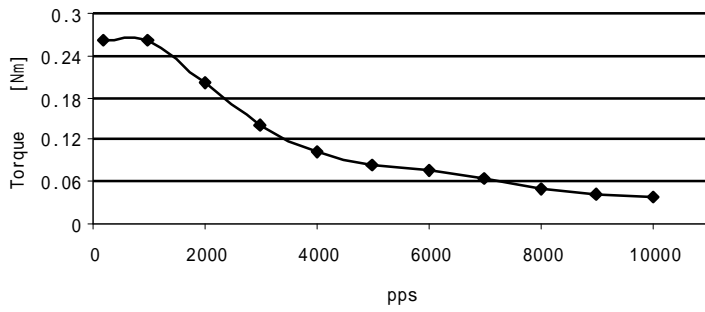

BL42STH47-1684MA
VM: 30VDC; 1.77A /相 驱动器: HA335, 整步

